

# AUBO-iS3

## iS Series Collaborative Robot

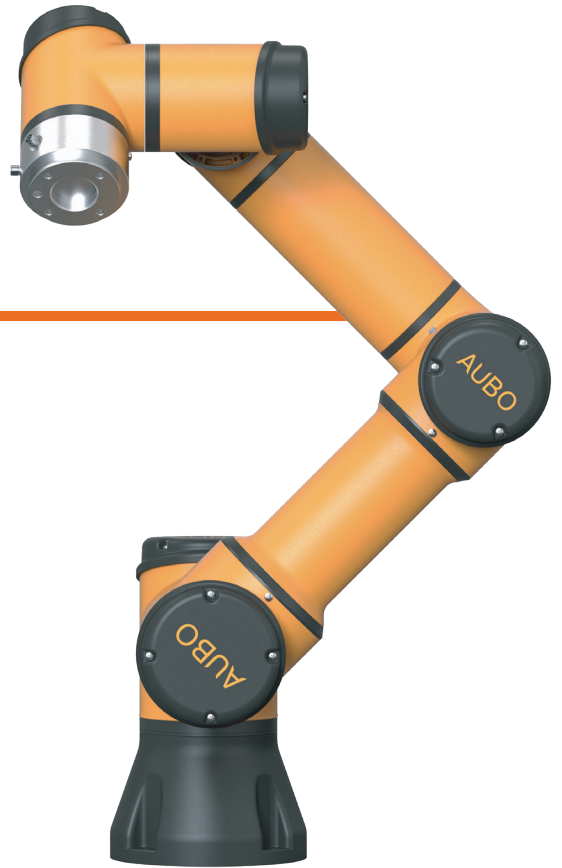

**3KG**  
PAYLOAD



**16KG**  
WEIGHT



**±0.02mm**  
REPEATABILITY



**625mm**  
WORKING RADIUS

- ✓ The AUBO-iS3 high-performance collaborative robot boasts a fast-operating robotic arm, capable of meeting the operational needs in complex and sensitive environments
- ✓ Payload: 3kg, arm span: 781mm, maximum working radius: 625mm
- ✓ High performance, fast response, compact and lightweight

### Applications

The AUBO iS series can be widely used across all industry scenarios, and is especially suitable for precision manufacturing, spraying, harsh/sensitive environments, and other special scenarios.



#### CERTIFICATIONS

- ISO 13849(PL d with Cat. 3)
- CE Certification
- NRTL Certification
- KCs Certification
- CR Certification
- SEMI S2 Certification
- RoHS Certification
- ISO class 4 Cleanroom ISO Class 4



### Features & Advantages

- 01 Modular and easy to replace:** Adopts an integrated modular design with 6 standard module specifications, enabling quick replacement and more convenient maintenance.
- 02 Enhanced performance, high precision, and high speed:** Compared to the i series, repeatability, absolute accuracy, and trajectory accuracy are comprehensively improved, and the robotic arm moves faster.
- 03 Brand new design, stronger protection:** The payload-to-weight ratio reaches up to 1:3.2, with optimized core components and new control algorithms; fully enclosed structure with a maximum IP68 protection rating.
- 04 Lightweight, flexible, and widely applicable:** The new teach pendant weighs only 1kg, and the new control cabinet reduces footprint by 50%; all models come standard with a multi-functional tool end, expanding the application range.



High Performance



High Precision



Rapid Response



Safe and Stable



Flexible Production



Fine Craftsmanship



Compact and Lightweight



Modular Design



High Protection Class



...

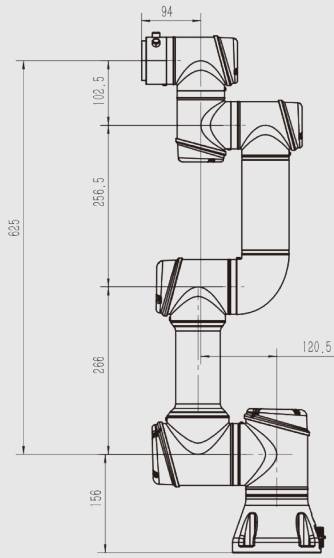

**AUBO-iS3 Dimensions Diagram**

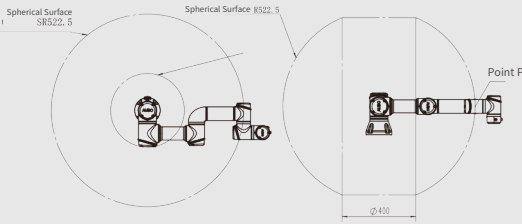

**AUBO-iS3 Point P Motion Range**

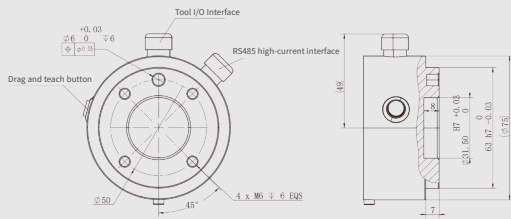

**AUBO-iS3 End Flange**

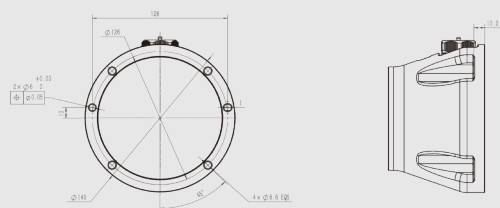

**AUBO-iS3 Base Top View**

### Robot

|                            |                          |
|----------------------------|--------------------------|
| Degrees of Freedom         | 6                        |
| Max Working Radius (mm)    | 625                      |
| Payload (kg)               | 3                        |
| Weight (kg)                | 16                       |
| Footprint Diameter (mm)    | Ø140                     |
| Repeatability (mm)         | ±0.02                    |
| Tool Speed (m/s)           | ≤2.5                     |
| Average Power (W)          | 150                      |
| Peak Power (W)             | 1000                     |
| Operating Temp. Range (°C) | 0-50                     |
| Operating Humidity         | 90% RH (Non-condensing)  |
| Mounting                   | Any angle                |
| IP Classification          | IP54 (IP67 customizable) |

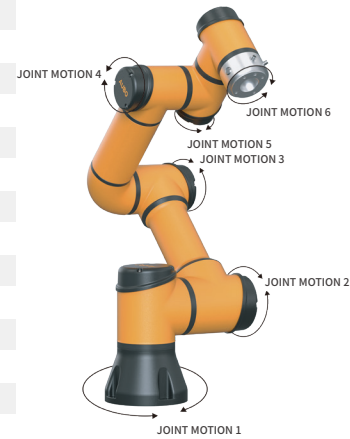

| Joint Motion | Range of Motion(°) | Max Speed (°/s) |
|--------------|--------------------|-----------------|
| joint 1      | ±360               | 237             |
| joint 2      | ±360               | 237             |
| joint 3      | ±156               | 237             |
| joint 4      | ±360               | 237             |
| joint 5      | ±360               | 237             |
| joint 6      | ±360               | 237             |

\* Joint motion capabilities may be limited by application scenarios; maximum speeds may not be reached. Please note this during use.

### Control Cabinet

|                            |  |
|----------------------------|--|
| Product Model              | AUBO-CB-iS   |
| Dimensions (L*H*W)         | 400mm*320mm*160mm  |
| Weight                     | 12.5kg   |
| Robot Arm Cable Length     | 5m (Customizable, up to 8m)  |
| Teach Pendant Cable Length | 4m   |
| Power Cable Length         | 5m   |
| Communication Protocols    | Ethernet, ModBus-RTU/TCP, Profinet, Ethernet/IP (Optional)                     |
| Interfaces & Openness      | SDK (C/C++/C#/Lua/Python/JavaScript Windows + Linux) 、 supporting ROS/ROS2, AP |
| Power Supply               | 115/230VAC, 50/60Hz  |
| IP Classification          | IP43   |



| I/O Interfaces      | Control Cabinet                         | Tool End    |
|---------------------|---|-------------|
| Digital Input       | 16(Standard),16(Configurable)/8(Safety) | 4(Standard) |
| Digital Output      | 16(Standard),16(Configurable)/8(Safety) | 4(Standard) |
| Analog Input        | 2                                       | 2           |
| Analog Output       | 2                                       | -           |
| RS485 Communication | 2                                       | 1           |
| I/O Power           |   |             |
| Output Voltage      | 24V                                     | 0V/12V/24V  |
| Output Current      | 3A Max                                  | 2A (3A Max) |

### Teach Pendant

|                    |                      |
|--------------------|----------------------|
| Product Model      | AUBO-TP-IS           |
| Dimensions (L*H*W) | 254mm*213.1mm*40.8mm |
| Weight             | 1.0kg                |
| IP Classification  | IP54                 |
| Color              | Orange + Black       |



### Disclaimer

1. The content of this product datasheet is subject to change without prior notice.
2. This product datasheet is the intellectual property of our company, and all rights are reserved. Any reproduction or citation of the content must indicate the source. Unauthorized reproduction is strictly prohibited; violators will be considered infringing and will be held legally liable in accordance with the law.



# AUBO-iS7

## iS Series Collaborative Robot

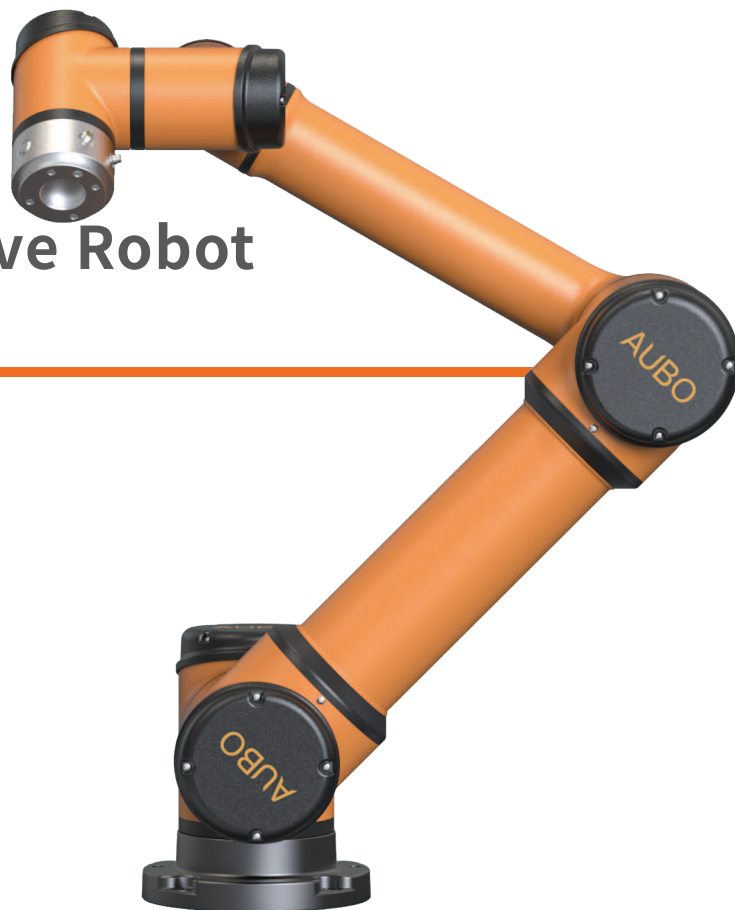

**7KG**  
PAYLOAD



**21.5KG**  
WEIGHT



**±0.02mm**  
REPEATABILITY



**886.5mm**  
WORKING RADIUS

- ✓ The AUBO-iS7 high-performance collaborative robot boasts a fast-operating robotic arm, capable of meeting the operational needs in complex and sensitive environments
- ✓ Payload: 7kg, arm span: 1008.5mm, maximum working radius: 886.5mm
- ✓ High performance, fast response, compact and lightweight

### Applications

The AUBO iS series can be widely used across all industry scenarios, and is especially suitable for precision manufacturing, spraying, harsh/sensitive environments, and other special scenarios.



#### CERTIFICATIONS

- ISO 13849(PL d with Cat. 3)
- CE Certification
- NRTL Certification
- KCs Certification
- CR Certification
- SEMI S2 Certification
- RoHS Certification
- ISO class 4 Cleanroom ISO Class 4



### Features & Advantages

- 01 Modular and easy to replace:** Adopts an integrated modular design with 6 standard module specifications, enabling quick replacement and more convenient maintenance.
- 02 Enhanced performance, high precision, and high speed:** Compared to the i series, repeatability, absolute accuracy, and trajectory accuracy are comprehensively improved, and the robotic arm moves faster.
- 03 Brand new design, stronger protection:** The payload-to-weight ratio reaches up to 1:3.2, with optimized core components and new control algorithms; fully enclosed structure with a maximum IP68 protection rating.
- 04 Lightweight, flexible, and widely applicable:** The new teach pendant weighs only 1kg, and the new control cabinet reduces footprint by 50%; all models come standard with a multi-functional tool end, expanding the application range.



High Performance



High Precision



Rapid Response



Safe and Stable



Flexible Production



Fine Craftsmanship



Compact and Lightweight



Modular Design



High Protection Class



...

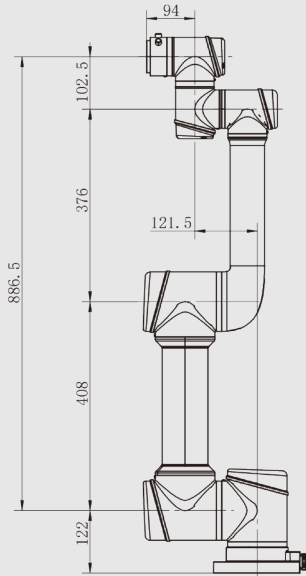

**AUBO-iS7 Dimensions Diagram**

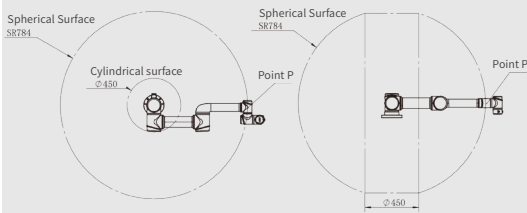

**AUBO-iS7 Point P Motion Range**

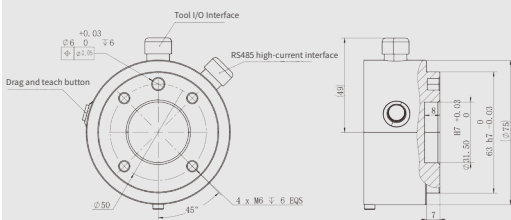

**AUBO-iS7 End Flange**

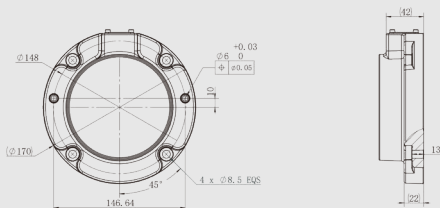

**AUBO-iS7 Base Top View**

### Robot

|                            |                         |
|----------------------------|-------------------------|
| Degrees of Freedom         | 6                       |
| Max Working Radius (mm)    | 886.5                   |
| Payload (kg)               | 7                       |
| Weight (kg)                | 21.5                    |
| Footprint Diameter (mm)    | Ø170                    |
| Repeatability (mm)         | ±0.02                   |
| Tool Speed (m/s)           | ≤3.6                    |
| Average Power (W)          | 200                     |
| Peak Power (W)             | 2000                    |
| Operating Temp. Range (°C) | 0-50                    |
| Operating Humidity         | 90% RH (Non-condensing) |
| Mounting                   | Any angle               |
| IP Classification          | IP67                    |

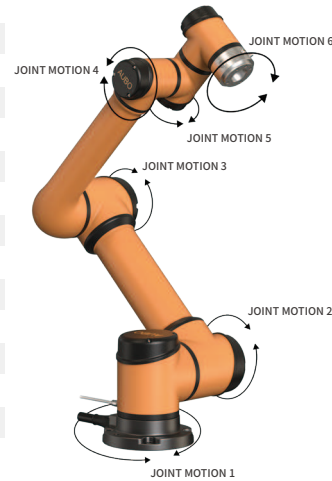

| Joint Motion | Range of Motion(°) | Max Speed (°/s) |
|--------------|--------------------|-----------------|
| joint 1      | ±360               | 237             |
| joint 2      | ±360               | 237             |
| joint 3      | ±162               | 237             |
| joint 4      | ±360               | 296             |
| joint 5      | ±360               | 296             |
| joint 6      | ±360               | 296             |

\* Joint motion capabilities may be limited by application scenarios; maximum speeds may not be reached. Please note this during use.

### Control Cabinet

|                            |  |
|----------------------------|--|
| Product Model              | AUBO-CB-iS   |
| Dimensions (L*H*W)         | 400mm*320mm*160mm  |
| Weight                     | 12.5kg   |
| Robot Arm Cable Length     | 5m (Customizable, up to 8m)  |
| Teach Pendant Cable Length | 4m   |
| Power Cable Length         | 5m   |
| Communication Protocols    | Ethernet, ModBus-RTU/TCP, Profinet, Ethernet/IP (Optional)                   |
| Interfaces & Openness      | SDK (C/C++/C#/Lua/Python/JavaScript Windows + Linux )、supporting ROS/ROS2、AP |
| Power Supply               | 115/230VAC, 50/60Hz  |
| IP Classification          | IP43   |



| I/O Interfaces | Control Cabinet     | Tool End                                |             |
|----------------|---------------------|---|-------------|
| I/O Interfaces | Digital Input       | 16(Standard),16(Configurable)/8(Safety) | 4(Standard) |
|                | Digital Output      | 16(Standard),16(Configurable)/8(Safety) | 4(Standard) |
|                | Analog Input        | 2                                       | 2           |
|                | Analog Output       | 2                                       | -           |
|                | RS485 Communication | 2                                       | 1           |
| I/O Power      | Output Voltage      | 24V                                     | 0V/12V/24V  |
|                | Output Current      | 3A Max                                  | 2A (3A Max) |

### Teach Pendant

|                    |                      |
|--------------------|----------------------|
| Product Model      | AUBO-TP-IS           |
| Dimensions (L*H*W) | 254mm*213.1mm*40.8mm |
| Weight             | 1.0kg                |
| IP Classification  | IP54                 |
| Color              | Orange + Black       |



### Disclaimer

- The content of this product datasheet is subject to change without prior notice.
- This product datasheet is the intellectual property of our company, and all rights are reserved. Any reproduction or citation of the content must indicate the source. Unauthorized reproduction is strictly prohibited; violators will be considered infringing and will be held legally liable in accordance with the law.



# AUBO-iS10

## iS Series Collaborative Robot

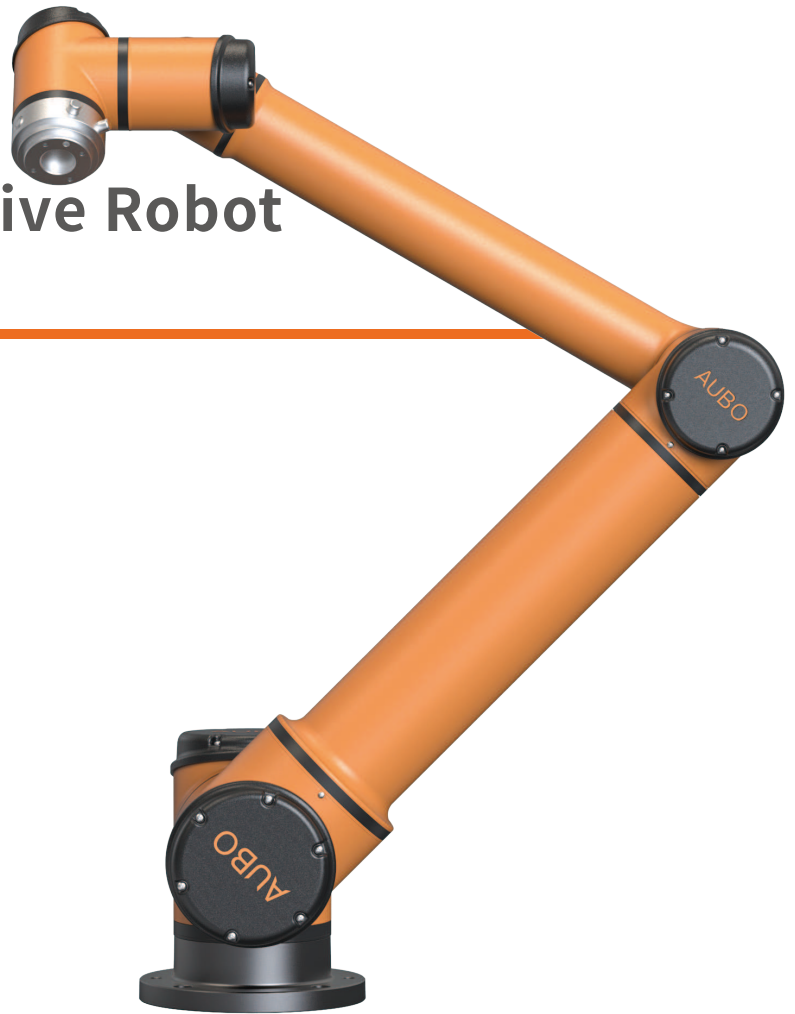

**12KG**  
PAYLOAD



**36KG**  
WEIGHT



**±0.03mm**  
REPEATABILITY



**1300mm**  
WORKING RADIUS

The AUBO-iS10 high-performance collaborative robot boasts a fast-operating robotic arm, capable of meeting the operational needs in complex and sensitive environments

- ✓ Payload: 12kg, arm span: 1457mm, maximum working radius: 1300mm
- ✓ High performance, fast response, compact and lightweight

### Applications

The AUBO iS series can be widely used across all industry scenarios, and is especially suitable for precision manufacturing, spraying, harsh/sensitive environments, and other special scenarios.



#### CERTIFICATIONS

- ISO 13849(PL d with Cat. 3)
- CE Certification
- NRTL Certification
- KCs Certification
- CR Certification
- SEMI S2 Certification
- RoHS Certification
- ISO class 4 Cleanroom ISO Class 4



### Features & Advantages

- 01 Modular and easy to replace:** Adopts an integrated modular design with 6 standard module specifications, enabling quick replacement and more convenient maintenance.
- 02 Enhanced performance, high precision, and high speed:** Compared to the i series, repeatability, absolute accuracy, and trajectory accuracy are comprehensively improved, and the robotic arm moves faster.
- 03 Brand new design, stronger protection:** The payload-to-weight ratio reaches up to 1:3.2, with optimized core components and new control algorithms; fully enclosed structure with a maximum IP68 protection rating.
- 04 Lightweight, flexible, and widely applicable:** The new teach pendant weighs only 1kg, and the new control cabinet reduces footprint by 50%; all models come standard with a multi-functional tool end, expanding the application range.



High Performance



High Precision



Rapid Response



Safe and Stable



Flexible Production



Fine Craftsmanship



Compact and Lightweight



Modular Design



High Protection Class



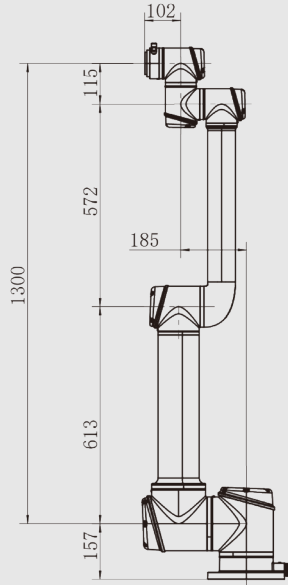

**AUBO-iS10 Dimensions Diagram**

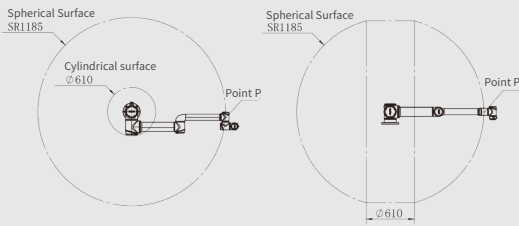

**AUBO-iS10 Point P Motion Range**

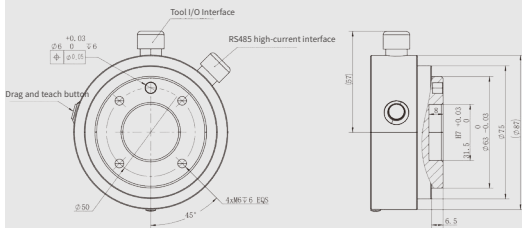

**AUBO-iS10 End Flange**

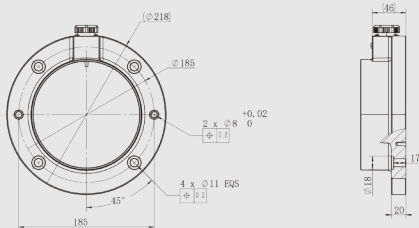

**AUBO-iS10 Base Top View**

### Robot

|                            |                         |
|----------------------------|-------------------------|
| Degrees of Freedom         | 6                       |
| Max Working Radius (mm)    | 1300                    |
| Payload (kg)               | 12                      |
| Weight (kg)                | 36                      |
| Footprint Diameter (mm)    | Ø218                    |
| Repeatability (mm)         | ±0.03                   |
| Tool Speed (m/s)           | ≤4.0                    |
| Average Power (W)          | 500                     |
| Peak Power (W)             | 2000                    |
| Operating Temp. Range (°C) | 0-50                    |
| Operating Humidity         | 90% RH (Non-condensing) |
| Mounting                   | Any angle               |
| IP Classification          | IP67                    |

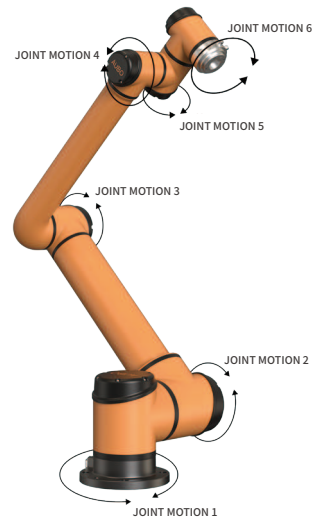

| Joint Motion | Range of Motion(°) | Max Speed (°/s) |
|--------------|--------------------|-----------------|
| joint 1      | ±360               | 178             |
| joint 2      | ±360               | 178             |
| joint 3      | ±167               | 237             |
| joint 4      | ±360               | 296             |
| joint 5      | ±360               | 296             |
| joint 6      | ±360               | 296             |

\* Joint motion capabilities may be limited by application scenarios; maximum speeds may not be reached. Please note this during use.

### Control Cabinet

|                            |  |
|----------------------------|--|
| Product Model              | AUBO-CB-iS   |
| Dimensions (L*H*W)         | 400mm*320mm*160mm  |
| Weight                     | 12.5kg   |
| Robot Arm Cable Length     | 5m (Customizable, up to 8m)  |
| Teach Pendant Cable Length | 4m   |
| Power Cable Length         | 5m   |
| Communication Protocols    | Ethernet, ModBus-RTU/TCP, Profinet, Ethernet/IP (Optional)                     |
| Interfaces & Openness      | SDK (C/C++/C#/Lua/Python/JavaScript Windows + Linux) , supporting ROS/ROS2, AP |
| Power Supply               | 115/230VAC, 50/60Hz  |
| IP Classification          | IP43   |



| I/O Interfaces               | Control Cabinet                         | Tool End    |
|------------------------------|---|-------------|
| I/O Interfaces Digital Input | 16(Standard),16(Configurable)/8(Safety) | 4(Standard) |
| Digital Output               | 16(Standard),16(Configurable)/8(Safety) | 4(Standard) |
| Analog Input                 | 2                                       | 2           |
| Analog Output                | 2                                       | -           |
| RS485 Communication          | 2                                       | 1           |
| I/O Power Output Voltage     | 24V                                     | 0V/12V/24V  |
| Output Current               | 3A Max                                  | 2A (3A Max) |

### Teach Pendant

|                    |                      |
|--------------------|----------------------|
| Product Model      | AUBO-TP-IS           |
| Dimensions (L*H*W) | 254mm*213.1mm*40.8mm |
| Weight             | 1.0kg                |
| IP Classification  | IP54                 |
| Color              | Orange + Black       |



### Disclaimer

- The content of this product datasheet is subject to change without prior notice.
- This product datasheet is the intellectual property of our company, and all rights are reserved. Any reproduction or citation of the content must indicate the source. Unauthorized reproduction is strictly prohibited; violators will be considered infringing and will be held legally liable in accordance with the law.



# AUBO-iS20

## iS Series Collaborative Robot



**20KG**

PAYLOAD



**64KG**

WEIGHT



**±0.05mm**

REPEATABILITY



**1647mm**

WORKING RADIUS

- ✓ The AUBO-iS20 high-performance collaborative robot boasts a fast-operating robotic arm, capable of meeting the operational needs in complex and sensitive environments
- ✓ Payload: 20kg, arm span: 1832.5mm, maximum working radius: 1647mm
- ✓ High performance, fast response, compact and lightweight

### Applications

The AUBO iS series can be widely used across all industry scenarios, and is especially suitable for precision manufacturing, spraying, harsh/sensitive environments, and other special scenarios.



### CERTIFICATIONS

- ISO 13849(PL d with Cat. 3)
- CE Certification
- NRTL Certification
- KCs Certification
- CR Certification
- SEMI S2 Certification
- RoHS Certification
- ISO class 4 Cleanroom ISO Class 4



### Features & Advantages

- 01 Modular and easy to replace:** Adopts an integrated modular design with 6 standard module specifications, enabling quick replacement and more convenient maintenance.
- 02 Enhanced performance, high precision, and high speed:** Compared to the i series, repeatability, absolute accuracy, and trajectory accuracy are comprehensively improved, and the robotic arm moves faster.
- 03 Brand new design, stronger protection:** The payload-to-weight ratio reaches up to 1:3.2, with optimized core components and new control algorithms; fully enclosed structure with a maximum IP68 protection rating.
- 04 Lightweight, flexible, and widely applicable:** The new teach pendant weighs only 1kg, and the new control cabinet reduces footprint by 50%; all models come standard with a multi-functional tool end, expanding the application range.



High Performance



High Precision



Rapid Response



Safe and Stable



Flexible Production



Fine Craftsmanship



Compact and Lightweight



Modular Design



High Protection Class





# AUBO-iS20L

## iS Series Collaborative Robot

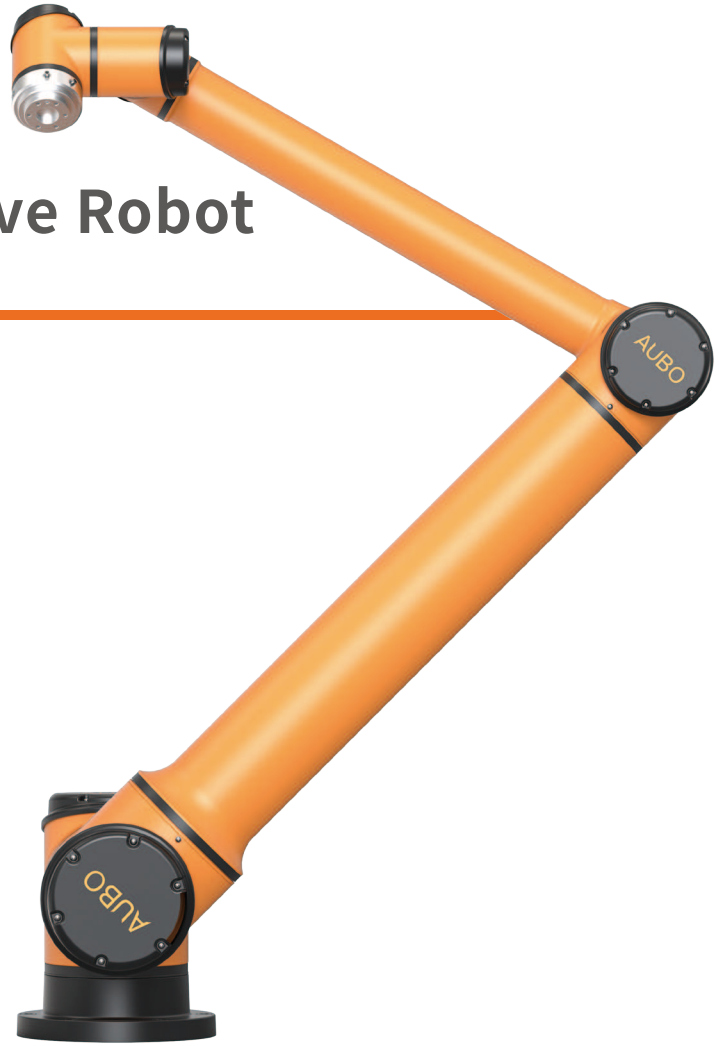

**20KG**

PAYLOAD



**72KG**

WEIGHT



**±0.05mm**

REPEATABILITY



**2000mm**

WORKING RADIUS

- ✓ The AUBO-iS20L high-performance collaborative robot boasts a fast-operating robotic arm, capable of meeting the operational needs in complex and sensitive environments
- ✓ Payload: 20kg, arm span:2210.5mm, maximum working radius:2000mm
- ✓ High performance, fast response, compact and lightweight

### Applications

The AUBO iS series can be widely used across all industry scenarios, and is especially suitable for precision manufacturing, spraying, harsh/sensitive environments, and other special scenarios.



#### CERTIFICATIONS

- ISO 13849(PL d with Cat. 3)
- CE Certification
- NRTL Certification
- KCs Certification
- CR Certification
- SEMI S2 Certification
- RoHS Certification
- ISO class 4 Cleanroom ISO Class 4



### Features & Advantages

- 01 Modular and easy to replace:** Adopts an integrated modular design with 6 standard module specifications, enabling quick replacement and more convenient maintenance.
- 02 Enhanced performance, high precision, and high speed:** Compared to the i series, repeatability, absolute accuracy, and trajectory accuracy are comprehensively improved, and the robotic arm moves faster.
- 03 Brand new design, stronger protection:** The payload-to-weight ratio reaches up to 1:3.2, with optimized core components and new control algorithms; fully enclosed structure with a maximum IP68 protection rating.
- 04 Lightweight, flexible, and widely applicable:** The new teach pendant weighs only 1kg, and the new control cabinet reduces footprint by 50%; all models come standard with a multi-functional tool end, expanding the application range.



High Performance



High Precision



Rapid Response



Safe and Stable



Flexible Production



Fine Craftsmanship



Compact and Lightweight



Modular Design



High Protection Class



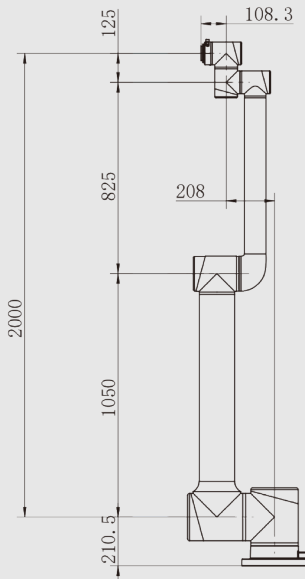

**AUBO-iS20L Dimensions Diagram**

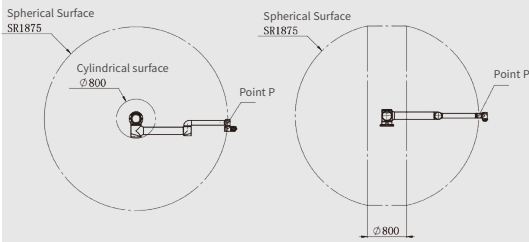

**AUBO-iS20L Point P Motion Range**

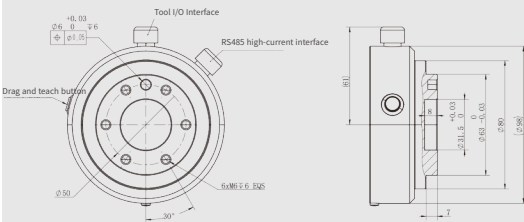

**AUBO-iS20L End Flange**

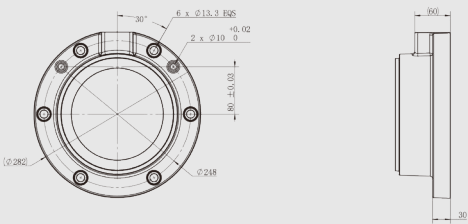

**AUBO-iS20L Base Top View**

### Robot

|                            |                         |
|----------------------------|-------------------------|
| Degrees of Freedom         | 6                       |
| Max Working Radius (mm)    | 2000                    |
| Payload (kg)               | 20                      |
| Weight (kg)                | 72                      |
| Footprint Diameter (mm)    | Ø282                    |
| Repeatability (mm)         | ±0.05                   |
| Tool Speed (m/s)           | ≤3.5                    |
| Average Power (W)          | 1000                    |
| Peak Power (W)             | 3000                    |
| Operating Temp. Range (°C) | 0-50                    |
| Operating Humidity         | 90% RH (Non-condensing) |
| Mounting                   | Any angle               |
| IP Classification          | IP54 (Up to IP67)       |

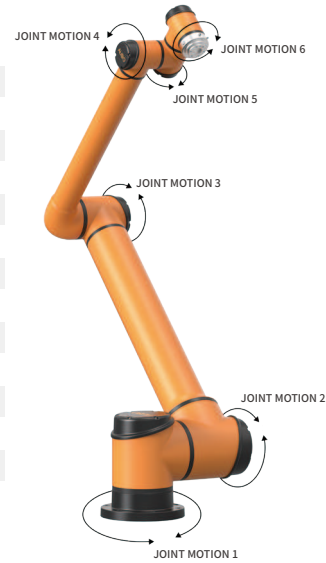

### Joint Motion

| Joint   | Range of Motion(°) | Max Speed (°/s) |
|---------|--------------------|-----------------|
| joint 1 | ±360               | 104             |
| joint 2 | ±360               | 104             |
| joint 3 | ±170               | 178             |
| joint 4 | ±360               | 296             |
| joint 5 | ±360               | 296             |
| joint 6 | ±360               | 296             |

\* Joint motion capabilities may be limited by application scenarios; maximum speeds may not be reached. Please note this during use.

### Control Cabinet

|                            |  |
|----------------------------|--|
| Product Model              | AUBO-CB-iS   |
| Dimensions (L*H*W)         | 400mm*320mm*160mm  |
| Weight                     | 12.5kg   |
| Robot Arm Cable Length     | 5m (Customizable, up to 8m)  |
| Teach Pendant Cable Length | 4m   |
| Power Cable Length         | 5m   |
| Communication Protocols    | Ethernet, ModBus-RTU/TCP, Profinet, Ethernet/IP (Optional)                     |
| Interfaces & Openness      | SDK (C/C++/C#/Lua/Python/JavaScript Windows + Linux) , supporting ROS/ROS2, AP |
| Power Supply               | 115/230VAC, 50/60Hz  |
| IP Classification          | IP43   |



### I/O Interfaces

|                     | Control Cabinet                         | Tool End    |
|---------------------|---|-------------|
| I/O Interfaces      |   |             |
| Digital Input       | 16(Standard),16(Configurable)/8(Safety) | 4(Standard) |
| Digital Output      | 16(Standard),16(Configurable)/8(Safety) | 4(Standard) |
| Analog Input        | 2                                       | 2           |
| Analog Output       | 2                                       | -           |
| RS485 Communication | 2                                       | 1           |
| I/O Power           |   |             |
| Output Voltage      | 24V                                     | 0V/12V/24V  |
| Output Current      | 3A Max                                  | 2A (3A Max) |

### Teach Pendant

|                    |                      |
|--------------------|----------------------|
| Product Model      | AUBO-TP-IS           |
| Dimensions (L*H*W) | 254mm*213.1mm*40.8mm |
| Weight             | 1.0kg                |
| IP Classification  | IP54                 |
| Color              | Orange + Black       |



### Disclaimer

1. The content of this product datasheet is subject to change without prior notice.
2. This product datasheet is the intellectual property of our company, and all rights are reserved. Any reproduction or citation of the content must indicate the source. Unauthorized reproduction is strictly prohibited; violators will be considered infringing and will be held legally liable in accordance with the law.



# AUBO-iS25

## iS Series Collaborative Robot

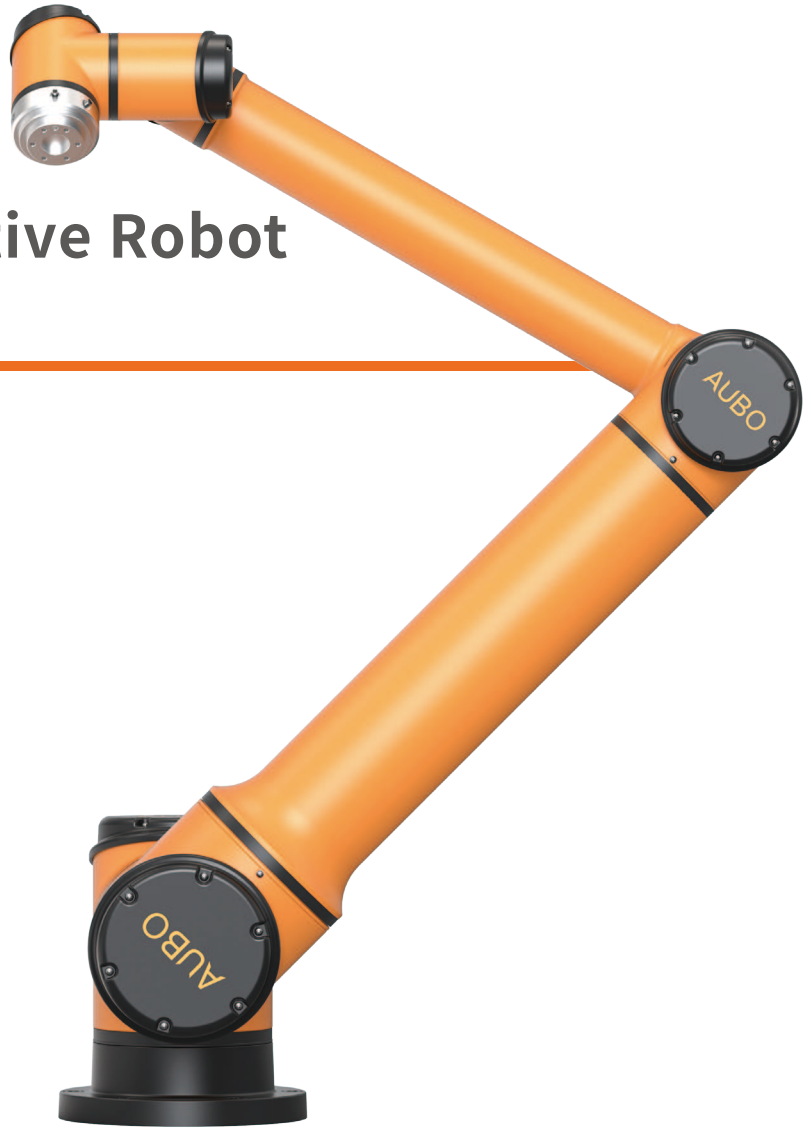

**25KG**

PAYLOAD



**75.6KG**

WEIGHT



**±0.05mm**

REPEATABILITY



**1700mm**

WORKING RADIUS

- ✓ The AUBO-iS25 high-performance collaborative robot boasts a fast-operating robotic arm, capable of meeting the operational needs in complex and sensitive environments
- ✓ Payload: 25kg, arm span: 1910.5mm, maximum working radius: 1700mm
- ✓ High performance, fast response, compact and lightweight

### Applications

The AUBO iS series can be widely used across all industry scenarios, and is especially suitable for precision manufacturing, spraying, harsh/sensitive environments, and other special scenarios.



#### CERTIFICATIONS

- ISO 13849(PL d with Cat. 3)
- CE Certification
- NRTL Certification
- KCs Certification
- CR Certification
- SEMI S2 Certification
- RoHS Certification
- ISO class 4 Cleanroom ISO Class 4



### Features & Advantages

- 01 Modular and easy to replace:** Adopts an integrated modular design with 6 standard module specifications, enabling quick replacement and more convenient maintenance.
- 02 Enhanced performance, high precision, and high speed:** Compared to the i series, repeatability, absolute accuracy, and trajectory accuracy are comprehensively improved, and the robotic arm moves faster.
- 03 Brand new design, stronger protection:** The payload-to-weight ratio reaches up to 1:3.2, with optimized core components and new control algorithms; fully enclosed structure with a maximum IP68 protection rating.
- 04 Lightweight, flexible, and widely applicable:** The new teach pendant weighs only 1kg, and the new control cabinet reduces footprint by 50%; all models come standard with a multi-functional tool end, expanding the application range.



High Performance



High Precision



Rapid Response



Safe and Stable



Flexible Production



Fine Craftsmanship



Compact and Lightweight



Modular Design



High Protection Class



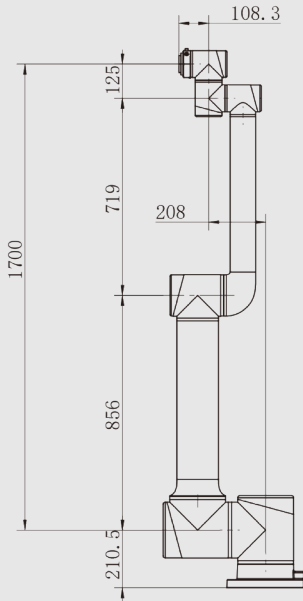

**AUBO-IS25** Dimensions Diagram

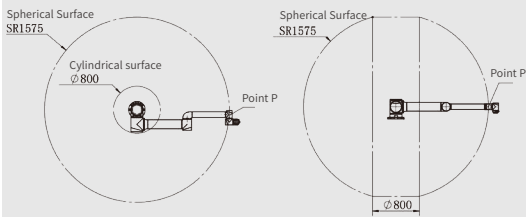

**AUBO-IS25** Point P Motion Range

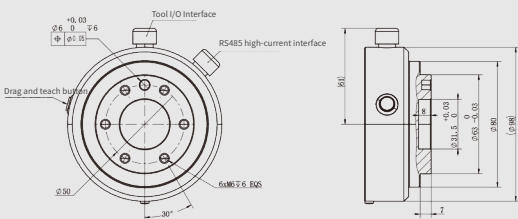

**AUBO-IS25** End Flange

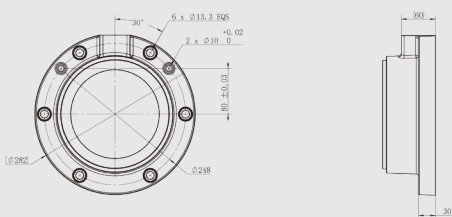

**AUBO-IS25** Base Top View

### Robot

|                            |                         |
|----------------------------|-------------------------|
| Degrees of Freedom         | 6                       |
| Max Working Radius (mm)    | 1700                    |
| Payload (kg)               | 25                      |
| Weight (kg)                | 75.6                    |
| Footprint Diameter (mm)    | Ø282                    |
| Repeatability (mm)         | ±0.05                   |
| Tool Speed (m/s)           | ≤3                      |
| Average Power (W)          | 1000                    |
| Peak Power (W)             | 3000                    |
| Operating Temp. Range (°C) | 0-50                    |
| Operating Humidity         | 90% RH (Non-condensing) |
| Mounting                   | Any angle               |
| IP Classification          | IP54 (Up to IP67)       |

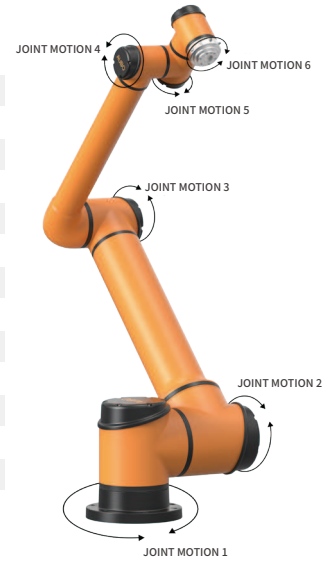

### Joint Motion

| Joint Motion | Range of Motion(°) | Max Speed (°/s) |
|--------------|--------------------|-----------------|
| joint 1      | ±360               | 104             |
| joint 2      | ±360               | 104             |
| joint 3      | ±166               | 178             |
| joint 4      | ±360               | 296             |
| joint 5      | ±360               | 296             |
| joint 6      | ±360               | 296             |

\* Joint motion capabilities may be limited by application scenarios; maximum speeds may not be reached. Please note this during use.

### Control Cabinet

|                            |  |
|----------------------------|--|
| Product Model              | AUBO-CB-iS   |
| Dimensions (L*H*W)         | 400mm*320mm*160mm  |
| Weight                     | 12.5kg   |
| Robot Arm Cable Length     | 5m (Customizable, up to 8m)  |
| Teach Pendant Cable Length | 4m   |
| Power Cable Length         | 5m   |
| Communication Protocols    | Ethernet, ModBus-RTU/TCP, Profinet, Ethernet/IP (Optional)                     |
| Interfaces & Openness      | SDK (C/C++/C#/Lua/Python/JavaScript Windows + Linux) 、 supporting ROS/ROS2, AP |
| Power Supply               | 115/230VAC, 50/60Hz  |
| IP Classification          | IP43   |



### I/O Interfaces

|                     | Control Cabinet                         | Tool End    |
|---------------------|---|-------------|
| I/O Interfaces      |   |             |
| Digital Input       | 16(Standard),16(Configurable)/8(Safety) | 4(Standard) |
| Digital Output      | 16(Standard),16(Configurable)/8(Safety) | 4(Standard) |
| Analog Input        | 2                                       | 2           |
| Analog Output       | 2                                       | -           |
| RS485 Communication | 2                                       | 1           |
| I/O Power           |   |             |
| Output Voltage      | 24V                                     | 0V/12V/24V  |
| Output Current      | 3A Max                                  | 2A (3A Max) |

### Teach Pendant

|                    |                      |
|--------------------|----------------------|
| Product Model      | AUBO-TP-IS           |
| Dimensions (L*H*W) | 254mm*213.1mm*40.8mm |
| Weight             | 1.0kg                |
| IP Classification  | IP54                 |
| Color              | Orange + Black       |



### Disclaimer

1. The content of this product datasheet is subject to change without prior notice.  
 2. This product datasheet is the intellectual property of our company, and all rights are reserved. Any reproduction or citation of the content must indicate the source. Unauthorized reproduction is strictly prohibited; violators will be considered infringing and will be held legally liable in accordance with the law.



# AUBO-iS35

## iS Series Collaborative Robot

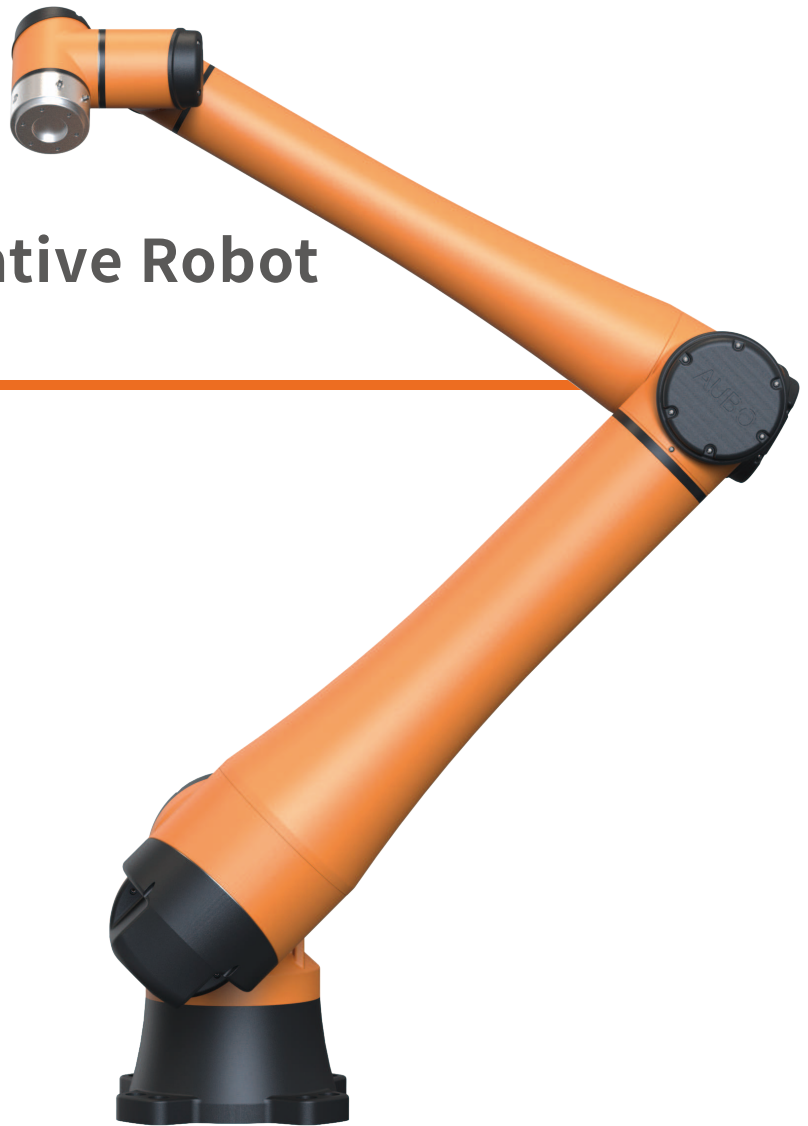

**35KG**

PAYLOAD



**172KG**

WEIGHT



**±0.05mm**

REPEATABILITY



**2100mm**

WORKING RADIUS

- ✓ It achieves a 35kg ultra-heavy payload.
- ✓ Its joints can rotate  $\pm 360^\circ$ .
- ✓ 2100mm maximum working radius and  $\pm 0.05$ mm repeatability
- ✓ It covers various heavy-payload application scenarios.

### Applications

The AUBO iS series can be widely used across all industry scenarios, and is especially suitable for precision manufacturing, spraying, harsh/sensitive environments, and other special scenarios.



#### CERTIFICATIONS

- ISO 13849(PL d with Cat. 3)
- CE Certification
- NRTL Certification
- KCs Certification
- CR Certification
- SEMI S2 Certification
- RoHS Certification
- ISO class 4 Cleanroom ISO Class 4



### Features & Advantages

- 01 Modular and easy to replace:** Adopts an integrated modular design with 6 standard module specifications, enabling quick replacement and more convenient maintenance.
- 02 Enhanced performance, high precision, and high speed:** Compared to the i series, repeatability, absolute accuracy, and trajectory accuracy are comprehensively improved, and the robotic arm moves faster.
- 03 Brand new design, stronger protection:** The payload-to-weight ratio reaches up to 1:3.2, with optimized core components and new control algorithms; fully enclosed structure with a maximum IP68 protection rating.
- 04 Lightweight, flexible, and widely applicable:** The new teach pendant weighs only 1kg, and the new control cabinet reduces footprint by 50%; all models come standard with a multi-functional tool end, expanding the application range.



High Performance



High Precision



Rapid Response



Safe and Stable



Flexible Production



Fine Craftsmanship



Compact and Lightweight



Modular Design



High Protection Class



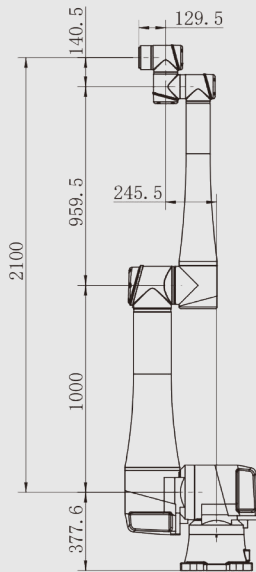

**AUBO-iS35 Dimensions Diagram**

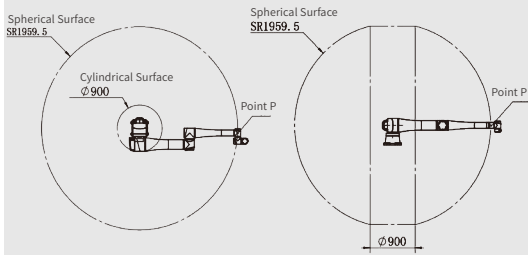

**AUBO-iS35 Point P Motion Range**

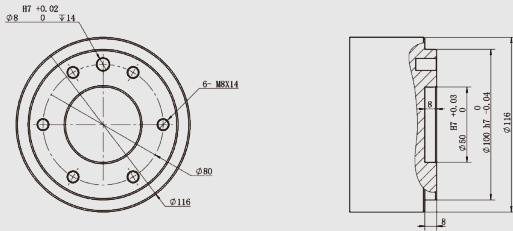

**AUBO-iS35 End Flange**

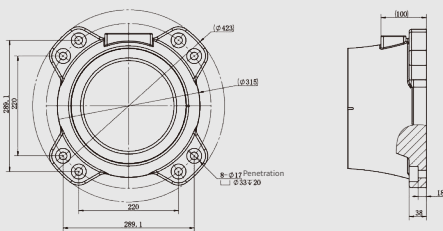

**AUBO-iS35 Base Top View**

### Robot

|                            |                         |
|----------------------------|-------------------------|
| Degrees of Freedom         | 6                       |
| Max Working Radius (mm)    | 2100                    |
| Payload (kg)               | 35                      |
| Weight (kg)                | 172                     |
| Footprint Diameter (mm)    | Ø423                    |
| Repeatability (mm)         | ±0.05                   |
| Tool Speed (m/s)           | ≤4                      |
| Average Power (W)          | 2000 (Estimated)        |
| Peak Power (W)             | 6000 (Estimated)        |
| Operating Temp. Range (°C) | 0-50                    |
| Operating Humidity         | 90% RH (Non-condensing) |
| Mounting                   | Any angle               |
| IP Classification          | IP54 (Up to IP67)       |

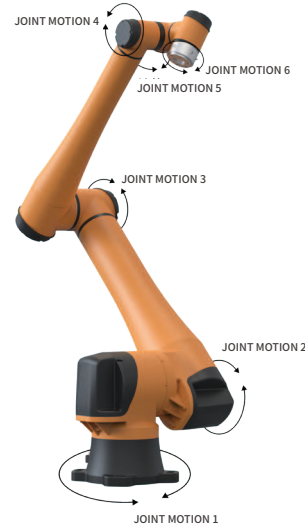

### Joint Motion

| Joint   | Range of Motion(°) | Max Speed (°/s) |
|---------|--------------------|-----------------|
| joint 1 | ±360               | 113             |
| joint 2 | ±360               | 113             |
| joint 3 | ±168               | 123             |
| joint 4 | ±360               | 237             |
| joint 5 | ±360               | 237             |
| joint 6 | ±360               | 237             |

\*Joint motion capabilities may be limited by application scenarios; maximum speeds may not be reached. Please note this during use.

### Control Cabinet

|                            |   |       |
|----------------------------|---|-------|
| Product Model              | AUBO-CB-iS-H  |       |
| Dimensions (L*H*W)         | 440mm*320mm*240mm   |       |
| Weight                     | 18kg  | 320mm |
| Robot Arm Cable Length     | 5m (Customizable, up to 8m)   |       |
| Teach Pendant Cable Length | 4m  |       |
| Power Cable Length         | 5m  |       |
| Communication Protocols    | Ethernet, ModBus-RTU/TCP, Profinet, Ethernet/IP (Optional)                    |       |
| Interfaces & Openness      | SDK (C/C++/C#/Lua/Python/JavaScript Windows + Linux), supporting ROS/ROS2, AP |       |
| Power Supply               | 115/230VAC, 50/60Hz   |       |
| IP Classification          | IP43  |       |



### I/O Interfaces

| I/O Interfaces      | Control Cabinet                         | Tool End |
|---------------------|---|----------|
| Digital Input       | 16(Standard),16(Configurable)/8(Safety) | -        |
| Digital Output      | 16(Standard),16(Configurable)/8(Safety) | -        |
| Analog Input        | 2                                       | -        |
| Analog Output       | 2                                       | -        |
| RS485 Communication | 2                                       | -        |
| I/O Power           |   |          |
| Output Voltage      | 24V                                     | -        |
| Output Current      | 3A Max                                  | -        |

### Teach Pendant

|                    |                      |
|--------------------|----------------------|
| Product Model      | AUBO-TP-IS           |
| Dimensions (L*H*W) | 254mm*213.1mm*40.8mm |
| Weight             | 1.0kg                |
| IP Classification  | IP54                 |
| Color              | Orange + Black       |



### Disclaimer

- The content of this product datasheet is subject to change without prior notice.
- This product datasheet is the intellectual property of our company, and all rights are reserved. Any reproduction or citation of the content must indicate the source. Unauthorized reproduction is strictly prohibited; violators will be considered infringing and will be held legally liable in accordance with the law.

